



WESTMINSTER DEPARTMENT OF PUBLIC WORKS
P.O. BOX 376 WESTMINSTER, MA 01473 - Tel. (978) 874-5572

Commissioners
Lorraine J. Emerson, Chairman
Alan E. Bedard
Vance A. Butterfield

Joshua W. Hall, P.E.
Director of Public Works

ESTABLISHMENT OF ENTRANCE TO PROPERTY FROM TOWN WAY

PERMIT REQUIRED

Prior to establishment of any entrance to your property, a sketch must be submitted on the back of this application, showing lot lines, any inlets or culverts and exact location of your proposed entrance.

Our Highway Department is concerned with width and flare of an entrance where it meets the road, since road surface is not to be disturbed and gutter line is to be maintained.

This application is submitted to the Director of Public Works and/or Highway Superintendent and on his approval; a permit will be issued by the Public Works Commission.

Date: _____

The undersigned _____

of _____ hereby applies for permission to:

on _____ Road/Street in the Town of Westminister.

Owner or Contractor for Owner

Address

Note: Should the location of the final driveway installation be different than the location herein indicated, it will be necessary to file for a new permit for the final driveway.

1. Indicate the lot and street that runs in front of it.
2. Make a street number sign; mark it with something that will not wash off when it rains. Tack it up on a tree or somewhere it can easily be seen from street.
3. Mark each boundary along the street side of the lot.
4. Measure the distance from each boundary to the proposed driveway and mark the distance on the drawing.
5. Measure the width of the proposed driveway and mark it on the drawing.
6. Find the nearest telephone pole and indicate its location on the drawing. Write the number of the pole on the drawing.
7. Measure the distance between the telephone pole and the proposed driveway and mark it on the drawing.

EXAMPLE

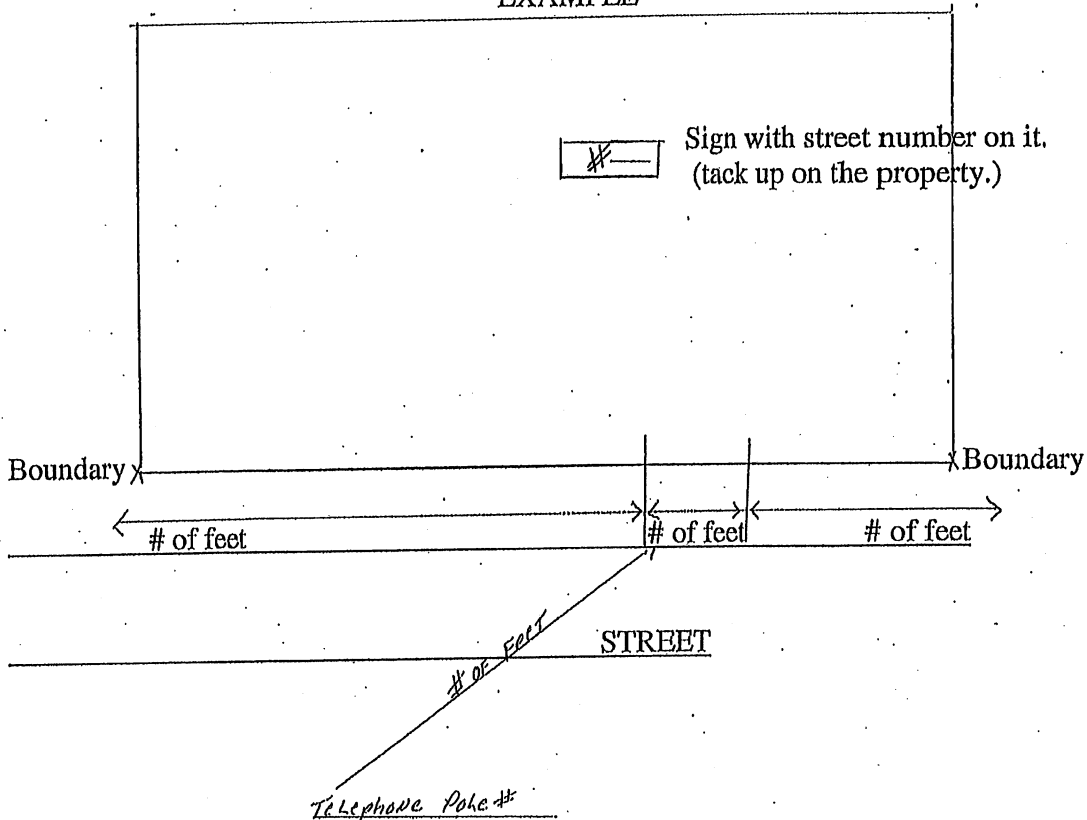

Note: if you have any questions, call the Highway Department at (978) 874-5572
Monday through Friday - 7:00 a.m. - 3:30 p.m.